



## Changzhou Suma Precision Machinery Co.,Ltd

Address: Liudao Industrial Park, Yaoguan Town, Wujin District, Changzhou City, Jiangsu Province, China 213102

Contact person: Ellen Zhang

Skype: suma.com5

Email: [ellen@chinasuma.com](mailto:ellen@chinasuma.com)

Tel: 0086 18068536660

### FXM Technical Parameter

#### Description

Integrated Freewheels FXM are without bearing support. Concentric alignment of inner and outer ring must be provided by the customer. The permissible run out (T.I.R.) must be observed.

The Integrated Freewheel FXM is centered via the outer track F on the customer attachment part and bolted to this (refer to figure 67-1). The tolerance of the pilot diameter of the attachment part must be ISO h6 or h7.

The tolerance of the shaft must be ISO h6 or j6. For fitting to shaft ends, end covers can be supplied upon request .

#### Lubrication

At speeds in excess of the sprag lift-off speed, no special lubrication is required; the freewheel functions maintenance-free. When operating below the sprag lift-off speed, an oil lubrication of the specified oil quality must be provided.

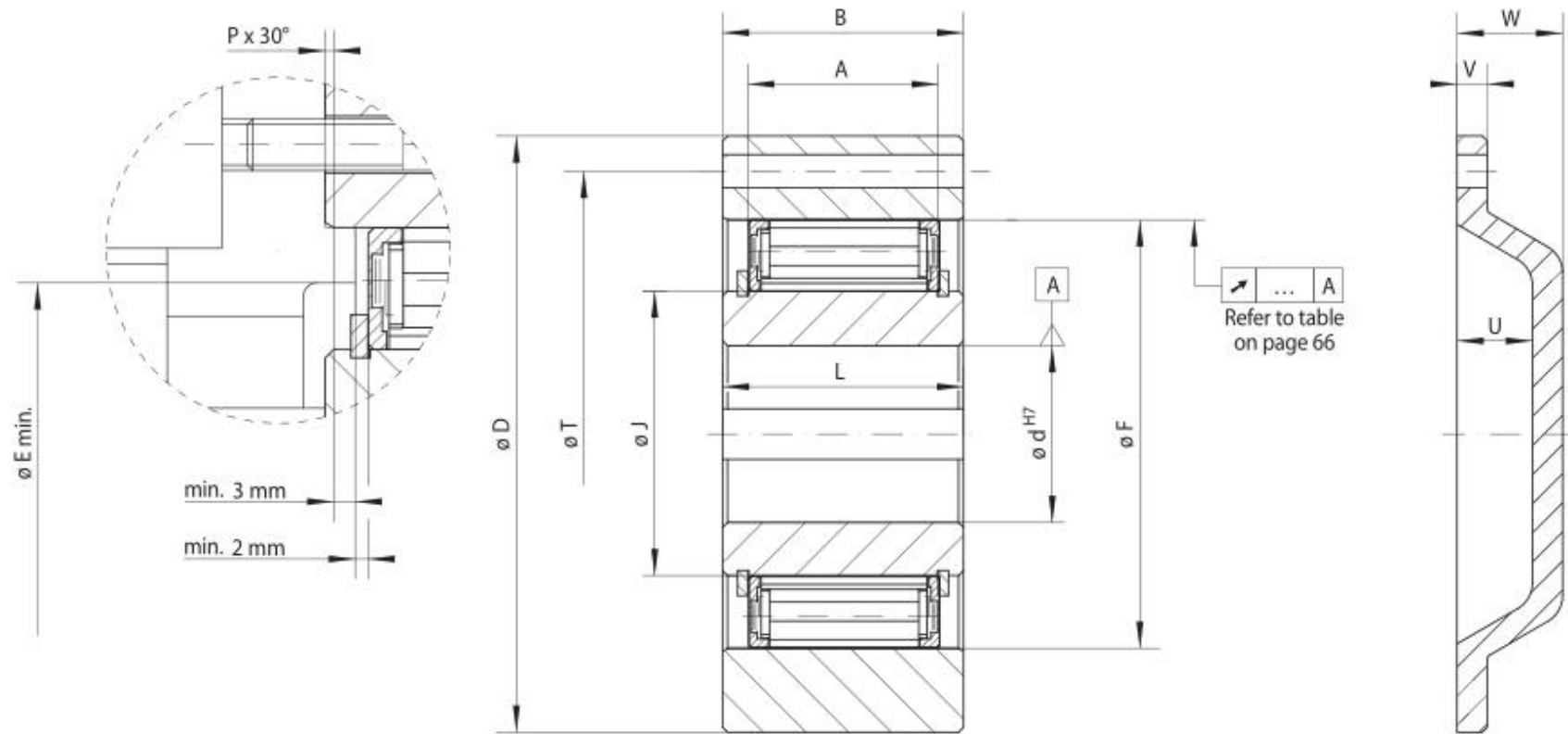

## Data Sheet

Type	d							A	B	D	E	F	G	J	L	P	T	U	V	W	Z <sup>**</sup>	Weight												
							mm															mm	mm	mm	mm	mm	mm	mm	mm	mm	mm	mm	mm	kg
	mm	mm	mm	mm	mm	mm	mm															mm	mm	mm	mm	mm	mm	mm	mm	mm	mm	mm	mm	mm
FXM 31 -17	20*						20*	17	25	85	41	55	M6	31	24	1,0	70	15	6	21	6	0,8												
FXM 38 -17	25*						25*	17	25	90	48	62	M6	38	24	1,0	75	15	6	21	6	0,9												

FXM 46 -25	25						30	25	35	95	56	70	M6	46	35	1,0	82	15	6	21	6	1,3
FXM 51 -25	25	30	35				36	25	35	105	62	75	M6	51	35	1,0	90	15	6	21	6	1,7
FXM 56 -25	35						40	25	35	110	66	80	M6	56	35	1,0	96	15	6	21	8	1,8
FXM 61 -19	30	35	40				45*	19	27	120	74	85	M8	61	25	1,0	105	15	6	21	6	1,8
FXM 66 -25	35	40	45				48*	25	35	132	82	90	M8	66	35	1,0	115	15	8	23	8	2,8
FXM 76 -25	45	55					60*	25	35	140	92	100	M8	76	35	1,0	125	15	8	23	8	3,1
FXM 86 -25	40	45	50	60	65		70*	25	40	150	102	110	M8	86	40	1,0	132	15	8	23	8	4,2
FXM 101 -25	55	70					80*	25	50	175	117	125	M10	101	50	1,0	155	20	8	28	8	6,9
FXM 85 -40	45	50	60	65			65	40	50	175	102	125	M10	85	60	1,0	155	20	8	28	8	7,4
FXM 100 -40	45	50	55	60	70	75	80*	40	50	190	130	140	M10	100	60	1,5	165	25	10	35	12	8,8
FXM 120 -50	60	65	70	75	80	95	95	50	60	210	150	160	M10	120	70	1,5	185	25	10	35	12	12,7
FXM 140 -50	65	90	100	110			110	50	70	245	170	180	M12	140	70	2,0	218	25	12	35	12	19,8
FXM 170 -63	70	85	90	100	120		130	63	80	290	200	210	M16	170	80	2,0	258	28	12	38	12	33,0
FXM 200 -63	130						155	63	80	310	230	240	M16	200	80	2,0	278	32	12	42	12	32,0
FXM 240 - 63							185	63	80	400	280	310	M20	240	90	2,0	360	48	15	60	12	60,0
FXM 240 - 96							185	96	125	420	280	310	M24	240	120	2,0	370	48	18	60	16	95,0
FXM 260 - 63							205	63	80	430	300	330	M20	260	105	2,0	380	48	18	60	16	75,0
FXM 290 - 70							230	70	80	460	330	360	M20	290	105	2,0	410	48	18	60	16	90,0
FXM 290 - 96							230	96	110	460	330	360	M20	290	120	2,0	410	48	18	60	16	91,0
FXM 310 - 70							240	70	125	497	360	380	M20	310	110	3,0	450	48	18	60	24	135,0
FXM 310 - 96							240	96	125	497	360	380	M20	310	120	3,0	450	48	18	60	24	145,0
FXM 320 - 70							250	70	80	490	360	390	M24	320	105	3,0	440	55	20	68	16	105,0
FXM 360 - 100							280	100	120	540	400	430	M24	360	125	3,0	500	55	20	68	24	170,0
FXM 410 - 100							320	100	120	630	460	480	M24	410	125	3,0	560	55	20	68	24	245,0
FXM 2410 - 100							320	200	220	630	460	480	M30	410	220	3,0	560	55	20	68	24	440,0

Pictures

